

HOMCOM

IN221000624V01_UK

824-009V70



Mist Fan, 16 Inch 220v-240v,50Hz, 90W

UK
CA CE

EN_IMPORTANT, RETAIN FOR FUTURE REFERENCE: READ CAREFULLY.

**FR_IMPORTANT: A LIRE ATTENTIVEMENT ET À CONSERVER POUR CONSULTATION
ULTÉRIEURE.**

ES_IMPORTANTE, LEA Y GUARDE PARA FUTURAS REFERENCIAS.

PT_IMPORTANTE, RETER PARA REFERÊNCIA FUTURA: LEIA ATENTAMENTE.

DE_WICHTIG! SORGFÄLTIG LESEN UND FÜR SPÄTER NACHSCHLAGEN AUFBEWAHREN.

**IT_IMPORTANTE! CONSERVARE IL PRESENTE MANUALE PER FUTURO RIFERIMENTO E
LEggerlo ATTENTAMENTE.**

WARNINGS

ATTENTION : read this booklet carefully it contains important instructions for a safe installation, use and maintenance.

Important instructions to be kept for future reference.

It is forbidden for the children to play with the device.

This device must be used only for the purpose it was expressly designed; any use not complying with the instructions contained in the manual is considered inappropriate and dangerous. The manufacturer is not responsible for possible damages caused by the inappropriate and/or unreasonable use.

This device is NOT suitable to use it in an explosive environment (in the presence of flammable substances such as gas, vapor, mist or dust, in atmospheric conditions when, after ignition, the combustion is spread in the air).

The packing materials (plastic bags, expanded polystyrene, etc.) must be kept out of the reach of children or disabled persons since they represent potential sources of danger.

The installation/assembly of the device will be made/ or according to the indications of the manufacturer. A wrong procedure may cause damages to persons, animals or objects, for which the manufacturer cannot be considered responsible.

Place and use the device on a horizontal and stable surface.

Before use check the integrity of the device and power cable. In case you are not sure contact a qualified person.

Before powering the device make sure the rating (voltage and frequency) corresponds to the grid and the socket is suitable for the plug of the device.

Make sure the power system is equipped with proper protection according to the law in force.

DO NOT power the device using multiple sockets.

If possible, avoid the use of adapters and/or extension cables; if their use is absolutely necessary, use only materials in compliance with the current safety regulations and according to the electrical parameters of the adapters.

The device must not be switched on using external timers and/or other remote control devices which are not specified in this manual.

DO NOT use or store the device near heat sources (heaters, stoves etc.).

DO NOT dip the device in water or other liquids; in case the accidental fall in the water DO NOT try to take it out, but first of all unplug immediately the power cable from the socket.

If you use the device for the first time, make sure to remove any label or protective sheet which blocks its proper functioning.

Technical information

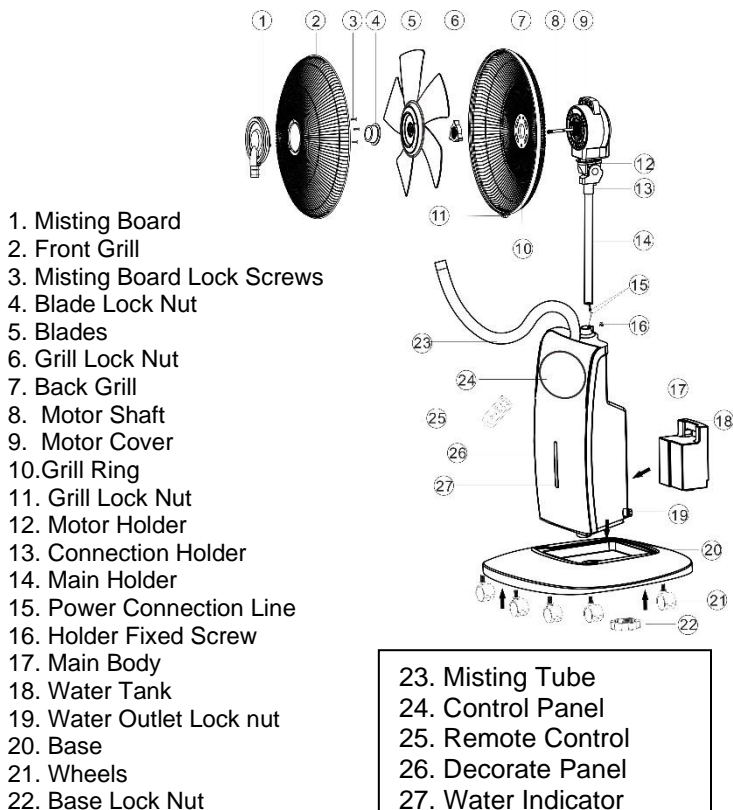

Assembling the appliance:

- Install the five castors on the base (20).
- Install the body (17) into the base (20) , and use the base lock nut (22) to screw on the base tightly.
- Connect power connection line (15) , and put it into the main body (17), and tight up by holder fixed screw (16).
- Install the back grill (7) , and tight up by grill lock nut (6) on the motor cover (12)
- Install the blades (5) on to the motor shaft (8), and anticlockwise by blade lock nut (4).

Installation

- Be sure to remove all packaging material from inside the appliance.
- Ensure that the fan is switched off from the supply mains before start any installation or assembly operation.
- The appliance should be used with its base fitted.
- Install misting board (1) on the front grill (2) and screw up by misting board lock screws (3).
- Put the front grill (2) and back grill (7) together, and screw to fasten by grill ring, and tight up by grill lock nut (11).

ATTENTION!

- Make sure the products unplugged from the mains before filling or refelling the water tank.
- Only use water in the water tank. Do not add any chemicals, oils or other additives.
- Only use cold or lukewarm water in the water tank. The water must not be warmer than 40°C.

Place the fan on a dry and stable surface and insert the plug on the socket; the unit will emit a short “BIP” sound indicating that power is supplied. For your convenience the unit can be operated by using control panel in the main body or by using remote control included.

Operation the appliance:

Control panel



Remote Control



Filling water:

- Push the water tank upward and remove the water tank.
- Unscrew the filler cap and fill with water.
- Screw the filler cap and put the water tank back in position.
- **CAUTION:** The temperature of water should not be 40° C above.

Operating the ice box:

- Turn off the appliance and pull out plug from the electrical outlet.
- Take out water tank, and then take out the ice box from appliance.
- Put the ice box into refrigerator for freezing
- After freezing, put the ice box on water holder make temperature lower.
- It can be reused.

Operating aroma tank:

- Take aroma case out on the body rear shell.
- Put several drops aroma liquid into the aroma case, and put the aroma case back in position.
- Slowly the aroma evaporates and be full of room while the mist fan working.

ON/OFF button:

- Firstly push ON/OFF button, the indicator light is on.
- Secondly push ON/OFF button, the wind speed is in the low level by default. Meanwhile, the indoor temperature shows on the panel.
- Thirdly push ON/OFF button, all stop working, all indicator lights off.

Speed button:

- Firstly push speed button, the wind speed is in the medium level
- Secondly push speed button, the wind speed is in the high level
- Thirdly push speed button, the wind speed returns to the low level.

Mode button:

- Natural mode → Sleep mode → Normal mode
- Natural mode : The wind imitate the blow of natural wind based on strong and soft wind.
- Sleep mode: the first half hour after running as strong and soft natural wind, it becomes med natural wind and the second half hour it changes to soft natural wind until the end of preset time.
- Normal mode: The wind blow based on Low/Med/High speed.

Mist function:

- Mist function can be used separately, or worked together with the fan.
 - Firstly push Mist button, the mist spray in low volume.
 - Secondly push Mist button, the mist spray in medium volume.
 - Thirdly push Mist button, the mist spray in high volume.
 - Note: While the mist function work normally, the indicator light on the body shell is blue, while the water is lacking, the indicator light is red.
- plus or minus pole.

Oscillation function:

- The oscillation function makes it possible to direct the flow from the apparatus so that it automatically alternates over a range of 75°
- To activate this function, push the OSC button. The yellow light of OSC on .
- Press it again to stop oscillation, yellow light of Osc off. Ionic function:
- Mist function can be used separately, or worked together with the fan.
- The appliance can generate negative ions generated by the ionizer emanate from the unit throughout the room and cause dust, pollen, pet dander etc to clump together and drop out of the air.
- Push the ion button, green light of Ion function on,
- Push it again to stop working, the green light of Ion function off.

Mosquito repellent function

- Mosquito repellent function can be used separately, or worked together with the fan.
- Put the mosquito repellent tablet (not included with the product) into its hole on the body rear shell.
- Push Mosquito button red light of mosquito repellent on, to avoid the mosquitoes annoy.
- Push it again to stop working, red light of mosquito repellent off.

Note:

- Turn off the power when you replacing the mosquito repellent tablet, wait for 10 minutes then replacement in order to avoid burns or electric shock.
 - Do not put the mosquito repellent tablet in contact with eyes or mouth. If put in mouth by accident, wash mouth and seek medical care immediately.
- **Note:** While the mist function work normally, the indicator light on the body shell is blue, while the water is lacking, the indicator light is red.
plus or minus pole.

CLEANING AND MAINTENANCE

NOTED: Before cleaning the appliance always disconnect the power plug from the receptacle.

1. DO NOT dip the device in water, or splash it with any other liquids.
2. DO NOT use solvents or any other chemical products for cleaning it. When you do not use it, after cleaning it, store the fan in a dry place.
3. When you have finished using the fan at the end of the season, wipe off any dust to maintain it in good working order for the next season; if necessary disassemble the grille and remove the fan; clean them with a soft damp cloth.
4. Remove the water tank and clean it with lukewarm water; before replace the water tank in the unit make sure it is completely dry. Draining the water out of the unit placing a container underneath the water drain (indicated with an arrow in below picture) and let any water remaining in the water reservoir drain out.

DISPOSAL

Used electric household devices



1. If you do not want to use your electrical appliance any longer, return it free of charge to a recycling depot for used electric appliances.

2. Used electric devices do not belong in the household garbage (see symbol)

Further disposal instructions

1. Return the electrical appliance in such a condition that its later re-use or recycling is not adversely affected. Batteries must be removed in advance and the destruction of parts which contain fluids must be avoided.

2. Electrical appliances can contain harmful substances. Improper handling or damage to the appliance can lead to health problems or water or ground contamination, when the appliance is recycled later.

SPECIFICATION

Product: Mist Fan

Model: TSP40-ED

Power: 90W

Voltage: 220V-240V / 50Hz

Made In China

All images serve as illustrations only and do not always show exact representations of the device.

All rights reserve

UK

If you have any questions, please contact our customer care center.

Our contact details are below:



0044-800-240-4004



enquiries@mhstar.co.uk

IMPORTER ADDRESS:

MH STAR UK LTD
Unit 27, Perivale Park,
Horsenden lane South
Perivale, UB6 7RH
MADE IN CHINA

DE

Wenn Sie Fragen haben, wenden Sie sich bitte an unser Kundendienstzentrum.

Unsere Kontaktdaten stehen unten:



0049-0(40)-88307530



service@aosom.de

ADRESSE DES IMPORTEUR:

MH Handel GmbH
Wendenstraße 309
D-20537 Hamburg
Germany
IN CHINA HERGESTELLT

ES

Si tiene alguna pregunta, comuníquese con nuestro Centro de Atención al Cliente.

Nuestros datos de contacto son los siguientes:



0034-931294512



atencioncliente@aosom.es

IMPORTADOR:

SPANISH AOSOM, S.L.
C/ ROC GROS, N° 15. 08550, ELS HOSTALETS DE
BALENYÀ, SPAIN.
B66295775
WWW.AOSOM.ES
ATENCIONCLIENTE@AOSOM.ES
TEL.: 931294512
HECHO EN CHINA

PT

Se tiver alguma dúvida, por favor contacte o nosso Centro de Atendimento ao Cliente.

Os nossos dados de contacto são os seguintes:



0034-931294512



info@aosom.pt

IMPORTADOR:

SPANISH AOSOM, S.L.
C.ROC GROS N.15, 08550. ELS HOSTALETS DE BALENYÀ
TEL: 931294512 (SEG-SEX DAS 7:30H ÀS 16:30H)
INFO@AOSOM.PT
WWW.AOSOM.PT

FR

Si vous avez la moindre question, veuillez contacter notre centre d'assistance à la clientèle.

Nos coordonnées sont les suivantes:



0033-1-84166106



aosom@mhfrance.fr

Importé par:

MH France
2, rue Maurice Hartmann
92130 Issy-les-Moulineaux
France
Fabriqué en Chine

IT

In caso di dubbio, si prega di contattare il nostro centro assistenza clienti.

I nostri dettagli di contatto sono di seguito:



0039-0249471447



clienti@aosom.it

IMPORTATO DA:

AOSOM Italy srl
Centro Direzionale Milanofiori
Strada 1 Palazzo F1
20057 Assago (MI)
P.I.: 08567220960
FATTO IN CINA