

**SPORTNOW**

IN221100592V01\_UK

**A62-034V00**

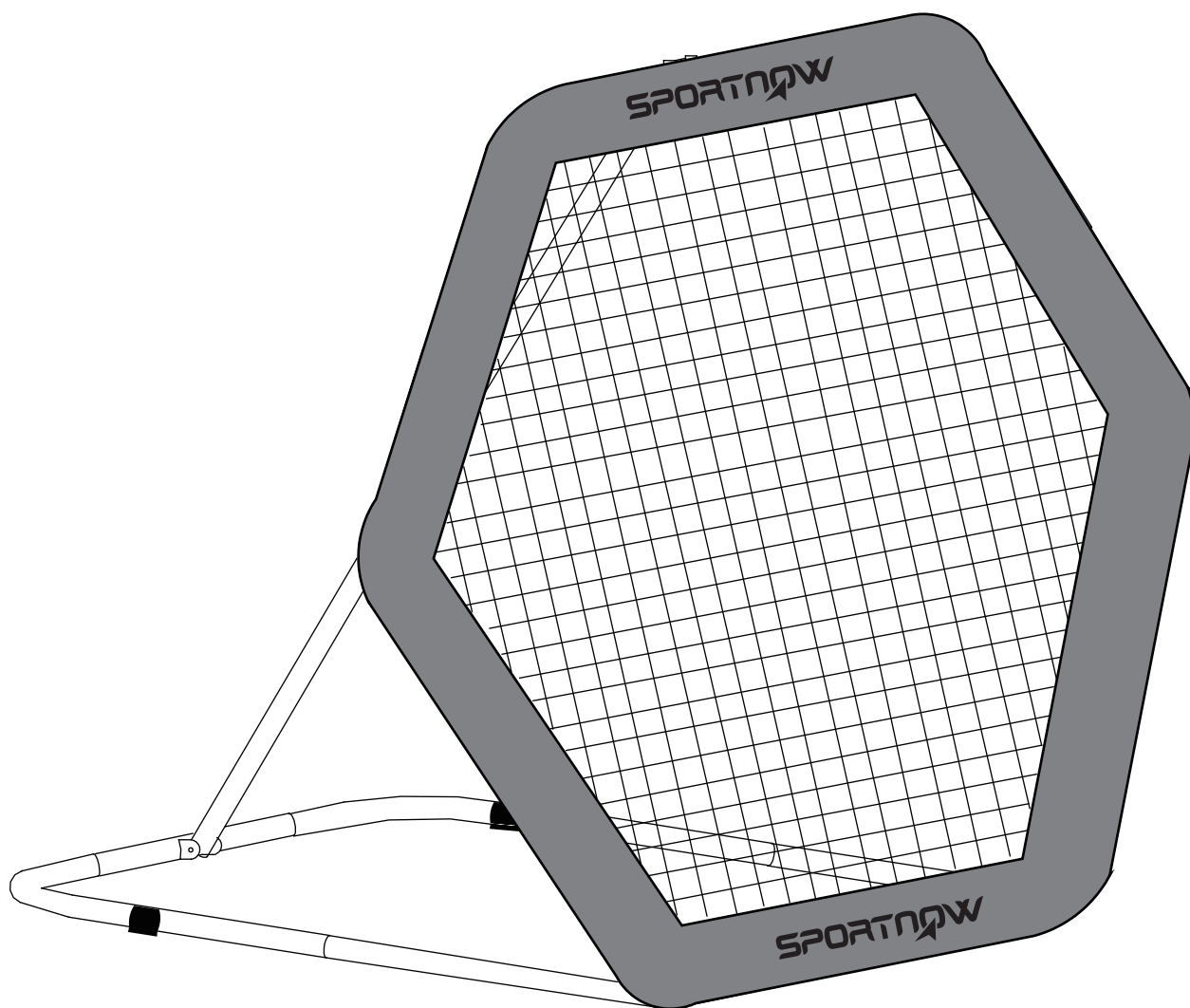



IMPORTANT, RETAIN FOR FUTURE REFERENCE: READ CAREFULLY

**ASSEMBLY INSTRUCTION**

**Dear customer,**

Thank you for purchasing this product. So that your appliance serves you well, please read all the instructions in this user's manual. If you have any questions, please contact our customer care center.

**Our contact details are below:**

Country	 Phone	 Email
UK	0044-800-240-4004	enquiries@mhstar.co.uk

**IMPORTER ADDRESS:**

MH STAR UK LTD  
Unit 27, Perivale Park,  
Horsenden lane South  
Perivale, UB6 7RH

MADE IN CHINA

**Warning:**

- \* Manufacturer suggests wearing safety goggles for net assembly, to protect against bungee cords hitting eye.
- \* As with any play equipment, children **MUST** be supervised at all times.
- \* Use product on a level surface. Never use near steps or stairs.
- \* For outdoor use only.
- \* Allow 8 feet from structures such as a fence, garage, house, overhanging branches, laundry lines, or electrical wires.
- \* Use common sense, and all the same precautions as you would when playing sport.
- \* Secure unit, so high winds do not blow it over.
- \* **NEVER** allow anyone (people or pets) to stand behind the net or in any possible path of a ball or puck should you miss the net or should the ball or puck go through the net.
- \* Never allow children to stand on unit. This could cause damage to unit and result in an injury.
- \* Do not use bungees for any other purposes other than to apply net.

① x 1

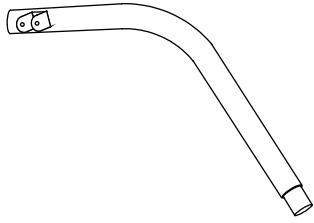

② x 3

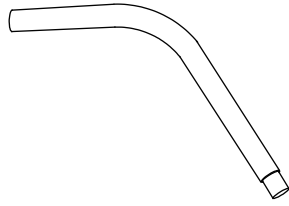

③ x 1

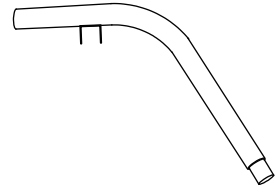

④ x 1

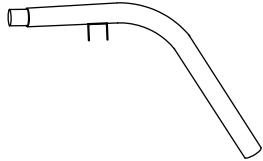

⑤ x 2

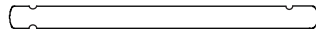

⑥ x 1

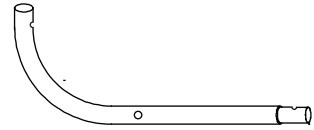

⑦ x 1

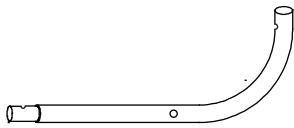

⑧ x 1

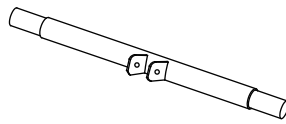

⑨ x 1

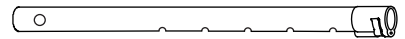

⑩ x 1

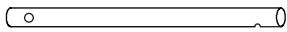

⑪ x 4

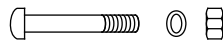

M8\*50MM

⑫ x 1

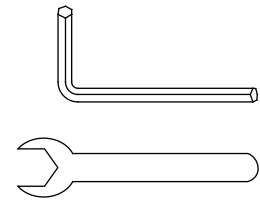

⑬ x 26



⑭ x 4



⑮ x 1

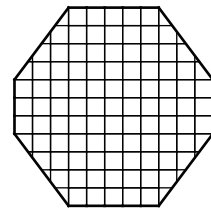

⑯ x 1



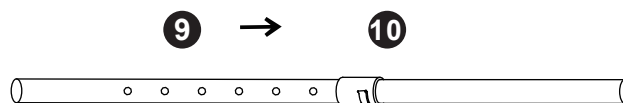
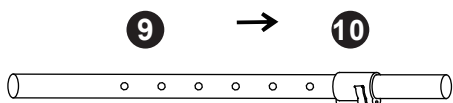

Tip: Tube 10 is in tube 9, pull tube 10 out of tube 9 when assemble the product frame.

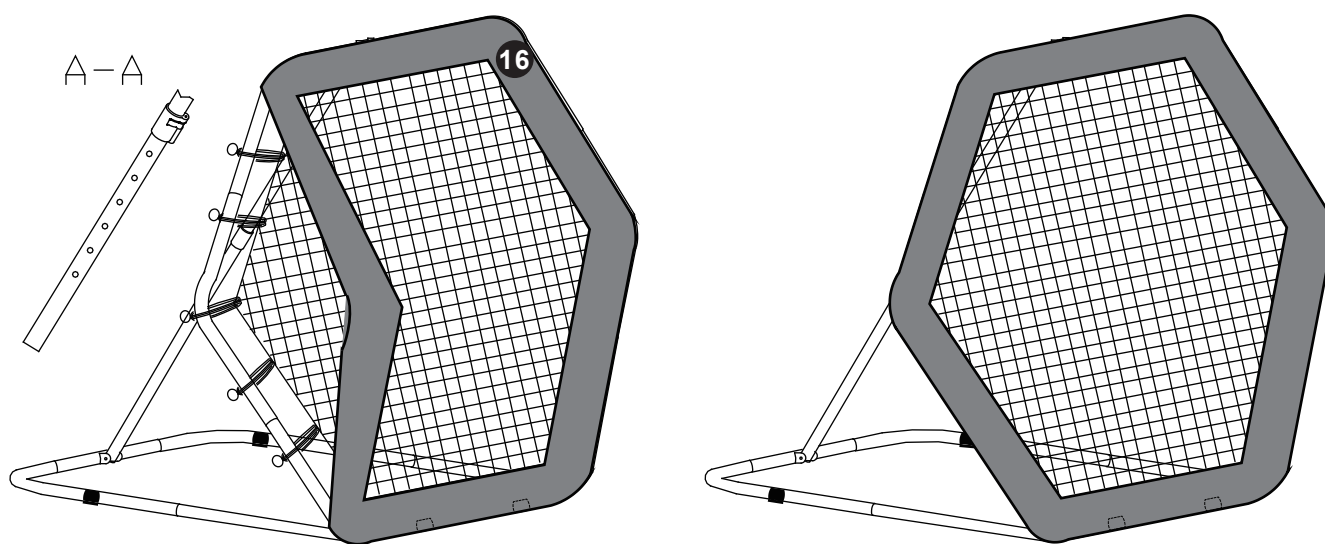
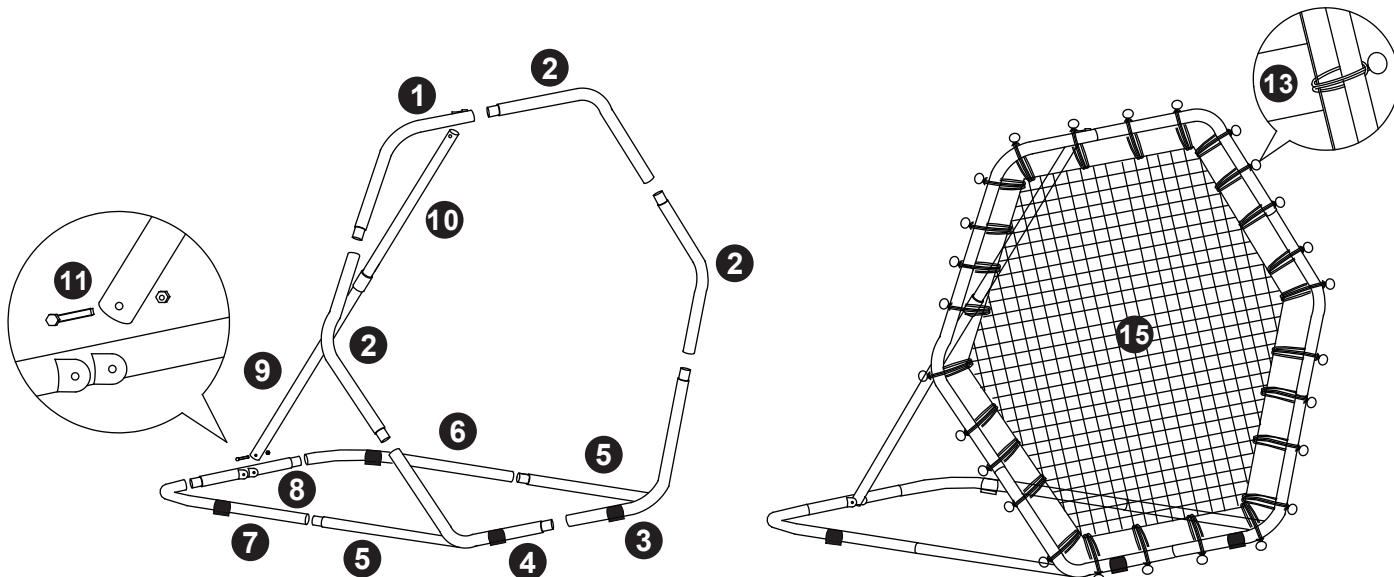

Tip:  
There are foot pad holes on the bottom part of net cover, please do not assemble in wrong position.  
The product must be assembled by adult.