

## CHILDREN'S TRICYCLE



**UK  
CA** **CE**



### **WARNING**

Must be assembled by an adult.

- Suitable for ages 18-36 months.
- Maximum user weight: 25kg.



### **ATTENTION**

This manual contains important safety, performance and maintenance information. Read the manual thoroughly before allowing your child to ride this product.

Failure to read the user manual can cause property damage or injury to persons. Keep this manual for future reference.

## Specification

<b>Suitable age:</b>	18-36 months
<b>Maximum load:</b>	25kg
<b>Dimensions:</b>	74 x 43 x 48cm

## Parts diagram and parts list



1. Body



2. Handlebar



3. Pedal



4. Front wheel



5. Rear wheel x 2



6. Mudguard



7. Rear axle x 2

## Parts diagram and parts list

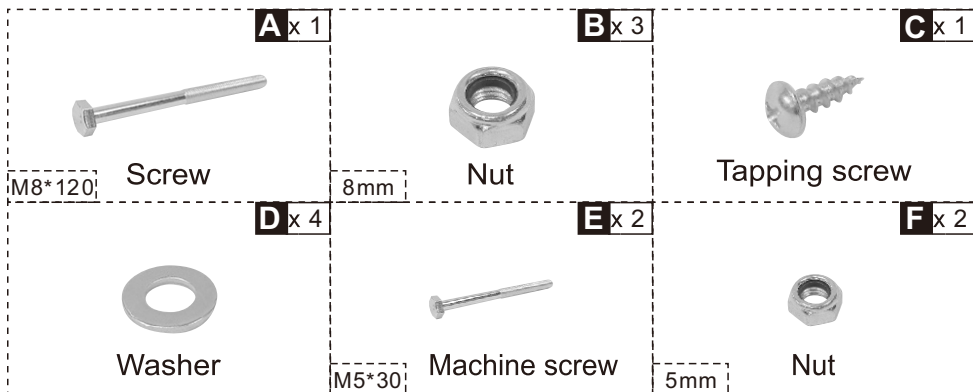
**B**

### Note:

All screws, nuts and plastic parts are preinstalled in their respective positions. Before installing the product, follow the steps to remove them.

- Assembly tools required:



Screwdriver wrench  
(not included)

## SAFETY

**C**

### **WARNING:**

PREVENT SERIOUS INJURY AND DEATH:

- NEVER LEAVE CHILDREN UNATTENDED WHEN RIDING THIS PRODUCT. ADULT SUPERVISION IS REQUIRED.
- To avoid falls and collisions, a certain level of skill is required when riding this product. Use this ride-on with caution to avoid injury and damage.
- Wear protective clothing when riding this product.
- Never use in roadways, near cars, on steep inclines or steps, swimming pools or other bodies of water.
- Always wear shoes. Always sit on the seat.
- Do not use in or near traffic.
- Due to its maximum speed, this product is NOT suitable for ages below 18 months. Maximum load is 25kg.
- This product does not have a brake.

### **WARNING:**

- **CHOKING HAZARD!** Not suitable for children under 18 months.
- Must be assembled by an adult.

## D Install mudguard, front wheels and rear axle assembly

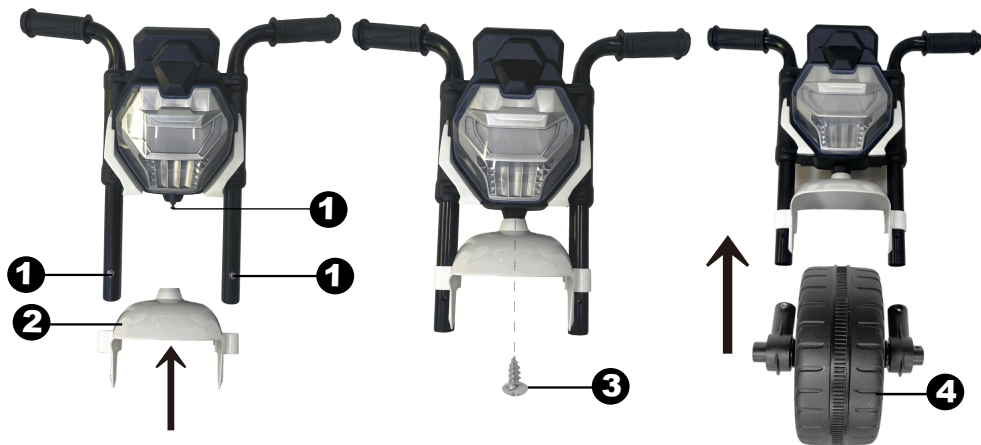

1. Remove preinstalled screws (C), two machine screws (E) and nut (F).
2. Insert the mudguard into the front fork.
3. Fix the mudguard with screw (C).
4. Insert the front wheel into the front fork.
5. Use machine screw (E) and nut (F) to secure the front wheel.
6. Insert the rear axle assembly into the body.

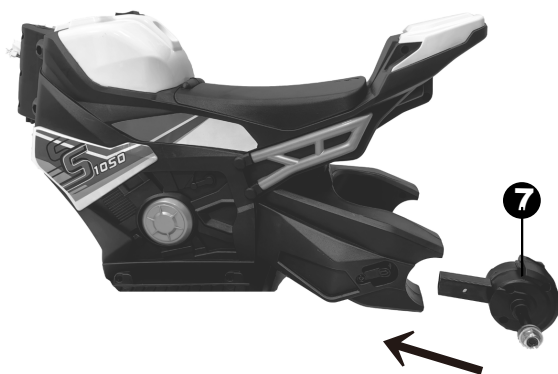
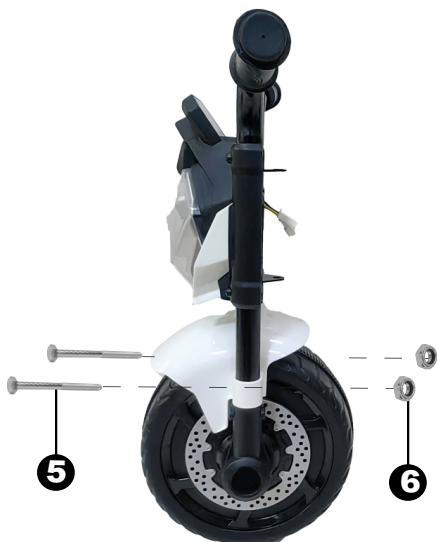

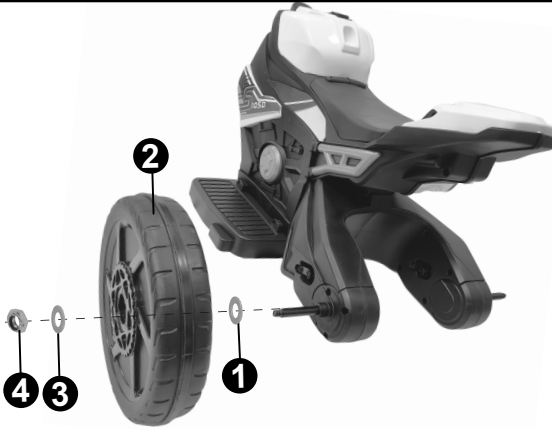
**D****Install rear wheels and handlebars**

1. Attach a washer (D) to the rear axle.
2. Attach the rear wheel to the rear axle.
3. Attach a washer (D) to the rear axle.
4. Tighten a lock nut (B) to the end of the rear axle with a spanner. **DO NOT** over-tighten.

To assemble the other rear wheel to the rear axle, repeat the above steps.

5. Connect the light line.
6. Align the holes on the body and handlebar, then insert and secure with one screw(A) and one nut (F) using the tools.

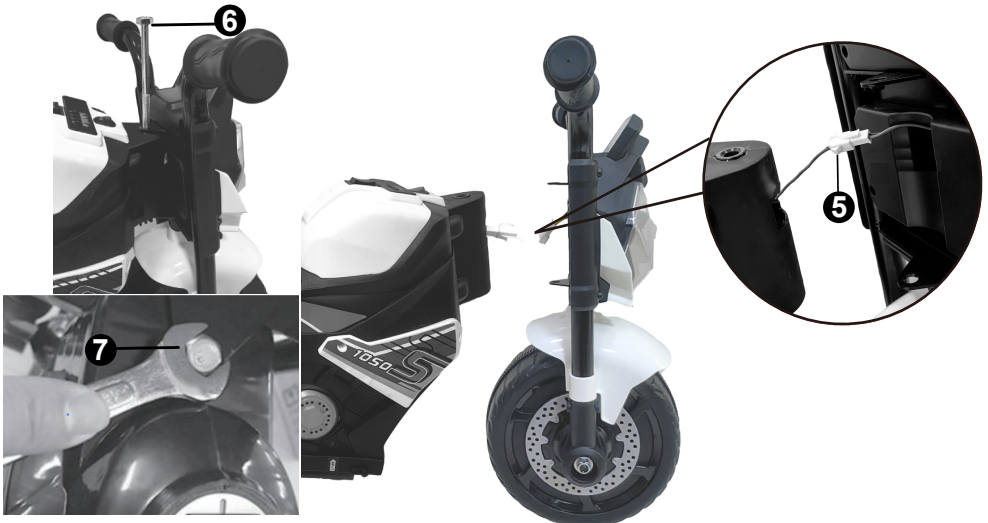

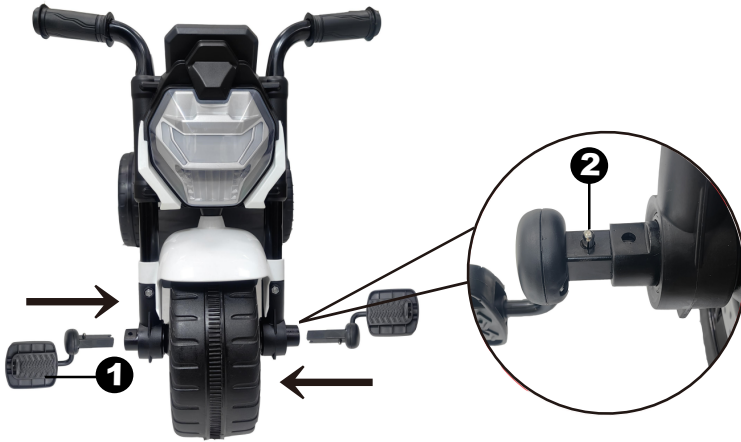
**D****Install foot pedals and batteries**

1. Insert the pedal into the front axle - the spring will pop out of the hole.
2. Remove the screw of the cell box and take off the cover.
3. Use three AA 1.5V batteries - ensure they are installed properly.
4. Close the cover and tighten the screw.

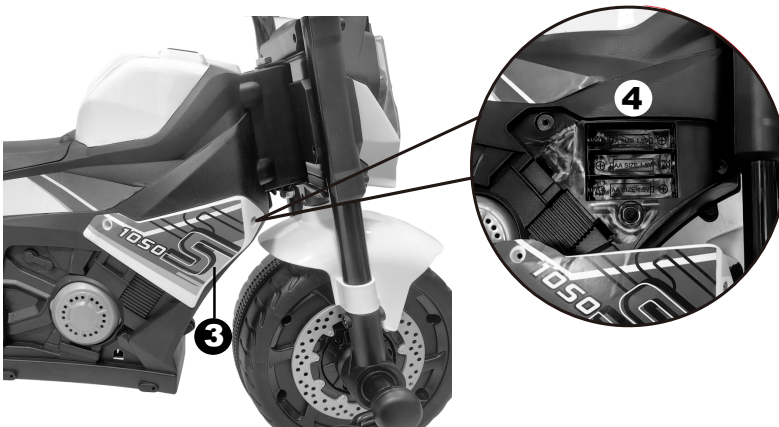
**BATTERY INFORMATION**

- Do not charge non-rechargeable batteries.
- Before charging rechargeable batteries, remove them from the product.
- Rechargeable batteries must be charged by adults only.
- Do not mix different or new and old batteries
- Insert batteries with the correct polarity.
- Remove exhausted batteries from the product.
- Do not short-circuit the supply terminals.

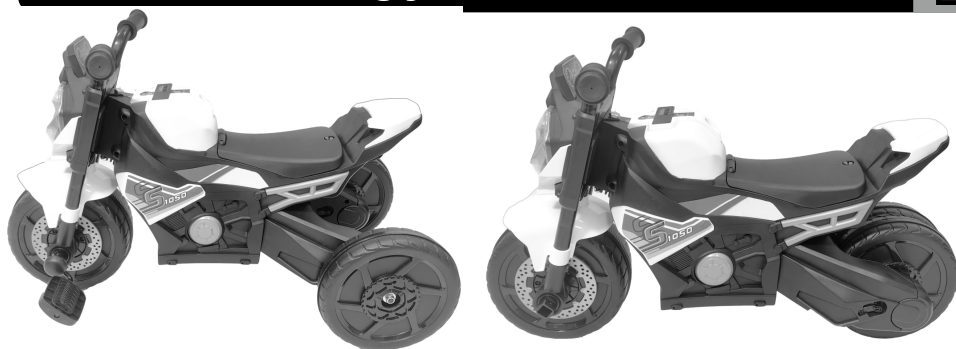

There are three modes: Tricycle, walker and balance.

### Mode 1 - switching from tricycle to balance ride-on:

1. Remove the rear wheel: Press the button on the inside of the rear wheel and pull it back.
2. Merge the wheel: Flip the removable wheel and install it back in its original position.
3. Remove the pedal: Use the tool to press the spring, then remove the pedal.

### Mode 2 - changing the balance ride-on into a tricycle:

1. Remove the rear wheel: Press the button on the outside of the rear wheel and pull it back.
2. Separate the wheels: Flip the removable wheels and install them back in their original position.
3. Install the pedal: Insert the pedal into the front axle - the spring will pop out of the hole.

Mode 3 - Changing the tricycle into a walker: Just remove the pedal from the front wheel.

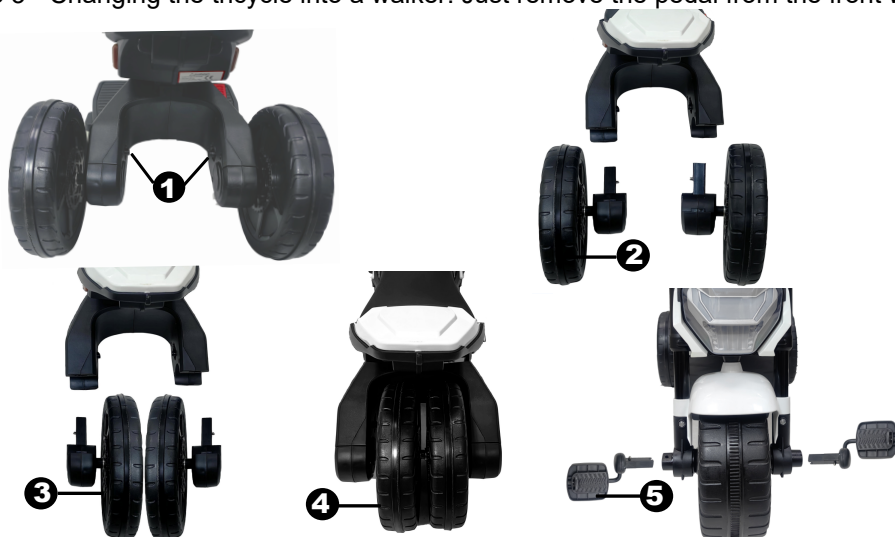

# E

## Use your new ride-on

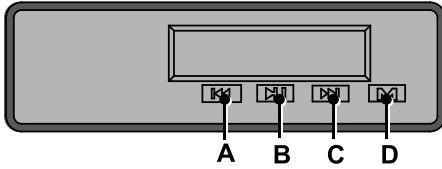

1. Foot pedals: Drive the ride-on forward.
2. Music player:
  - A. Song One
  - B. Song Two
  - C. Song Three
  - D. Horn sound

## Maintenance

# F

- **Adult responsibility:** Before using this ride-on, adults should check its main parts for potential hazards, like loose plugs or screws. If damages are found, the ride-on must not be used until it is fixed.
- **Check plastic parts:** Before using this ride-on, ensure plastic parts are not cracked or broken.
- **Lubrication:** Occasionally use lightweight oil to lubricate moving parts, such as the wheels, for smooth operation.
- **Storage:** Park the ride-on indoors or cover it with a tarp for protection against wet weather. Keep away from heat sources, as plastic parts could melt.
- **Cleaning:** Clean the ride-on with a soft, dry cloth. To restore shine to plastic parts, use a non-wax furniture polish. Avoid using car wax or abrasive cleaners.
- **Terrain:** Avoid driving the ride-on in loose dirt, sand or fine gravel - this could damage the moving parts, motors or electric system.
- **Power:** When not in use, turn off all electrical sources by switching off the power and disconnecting the battery.
- **Safety standards:** Our products meet safety standards like ASTM, F963, EN71 and EN62115.





If you have any questions, please contact our customer care center.  
Our contact details are below:



0044-800-240-4004



[enquiries@mhstar.co.uk](mailto:enquiries@mhstar.co.uk)

IMPORTER ADDRESS:  
MH STAR UK LTD  
Unit 27, Perivale Park,  
Horsenden lane South  
Perivale, UB6 7RH  
MADE IN CHINA